

Grand View Campus Map

- A** Grand View Hospital
- B** Emergency Medicine
- C** Children's Center
- D** Home Care
- E** Lifemark Medical Center
- F** The Summit Medical Center
- G** Sellersville Outpatient Center
- H** Recovery Room Thrift Shop
- I** Upper Bucks Medical Arts Building
- J** Human Resources
- K** Stoneridge Professional Center

GVH GRAND VIEW HEALTH

700 Lawn Avenue
Sellersville, PA 18960
215-453-4000
gvh.org



GVH GRAND VIEW HEALTH

**Wayfinding
During Hospital Expansion
and Construction**

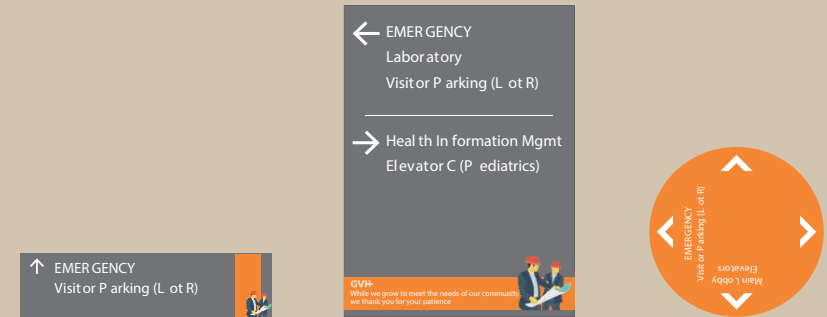

As we expand Grand View Hospital to bring the latest technologies and brightest facilities to you, please follow the orange and grey signs to find your way. You'll see them overhead, on the walls and on the floor.



FIRST FLOOR

- 1 Patient Registration
- 2 Outpatient Lab
- 3 Patient Financial Services
- 4 Maternal Fetal Medicine
- 5 Inpatient Physical Therapy
- 6 Patient Relations
- 7 Case Management
- 8 Volunteer Services
- 9 Cardiology/Cardiac Testing
- 10 Diagnostic Imaging (X-ray, CT, US, Nuclear Medicine, NIV)
- 11 Health Information Management
- 12 Gift Shop
- 13 Longacre Family Radiation Oncology
- 14 Emergency Medicine
- 15 Hospital Laboratory

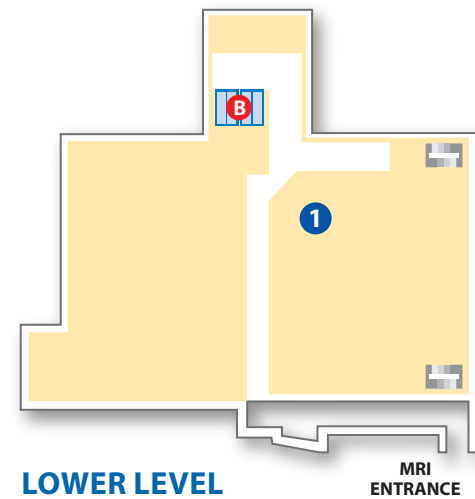

LOWER LEVEL

- 1 MRI Testing Center
Access from Main Lobby Elevator

VISITOR ELEVATORS

- A** to Progressive Care 3A
- B** Main Elevators
- C** Pediatrics and Outpatient Clinics
- D** to Joint Replacement Center/Orthopaedics and Acute Rehabilitation
- F** to Medical/Surgical Short Stay and ICU

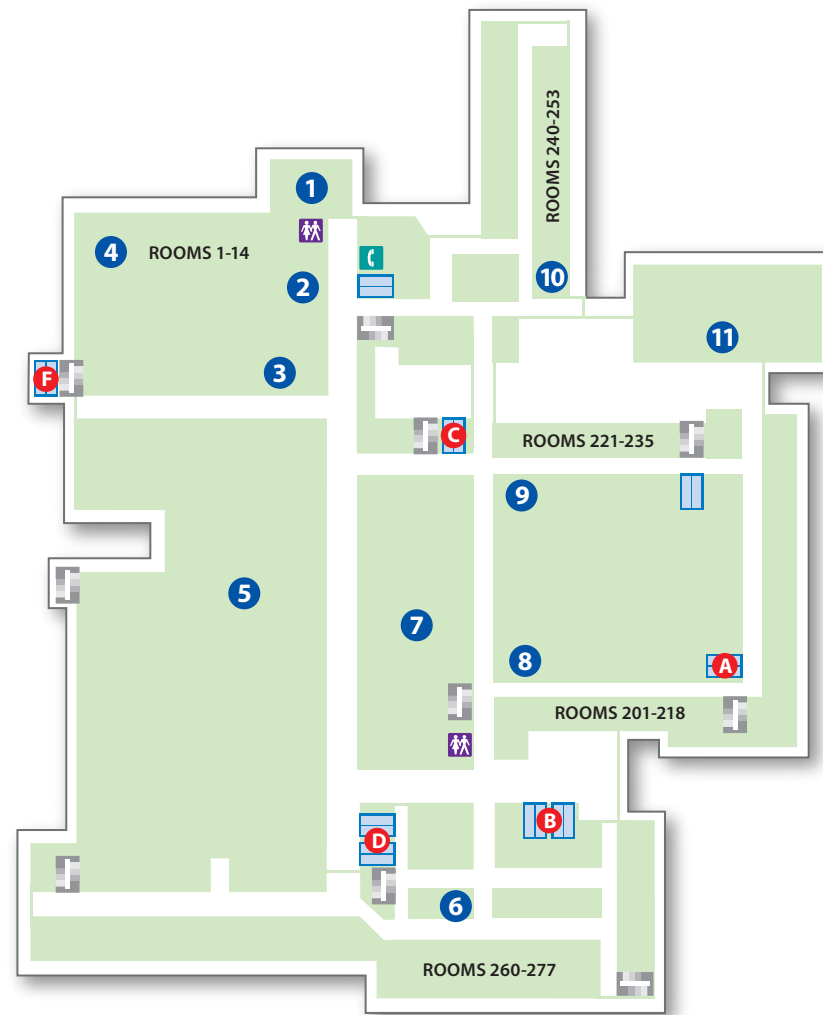

SECOND FLOOR

- 1 Waiting Area (Surgery & ICU)
- 2 Chapel
- 3 Medical/Surgical Short Stay Waiting Area
- 4 ICU (Rooms 1-14)
- 5 Inpatient/Outpatient Surgery
- 6 The Birth & Family Center (Rooms 260-277)
- 7 Cafeteria
- 8 Progressive Care 2A (Rooms 201-218)
- 9 Progressive Care 2B (Rooms 221-235)
- 10 Progressive Care 2C (Rooms 240-253)
- 11 The David M. Flowers, MD, Cardiac Catheterization Laboratory

THIRD FLOOR

- 1 Progressive Care 3A (Rooms 301-316)
- 2 Outpatient Clinics
Laser Eye, CHOP Cardiology, Ostomy Care
- 3 Pediatrics (Rooms 321-329)
- 4 Medical/Surgical Oncology 3E (Rooms 360-379)
- 5 Acute Rehabilitation 3D (Rooms 381-399)

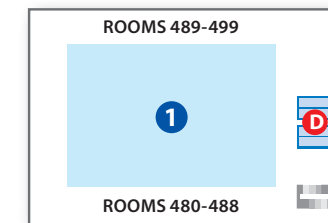
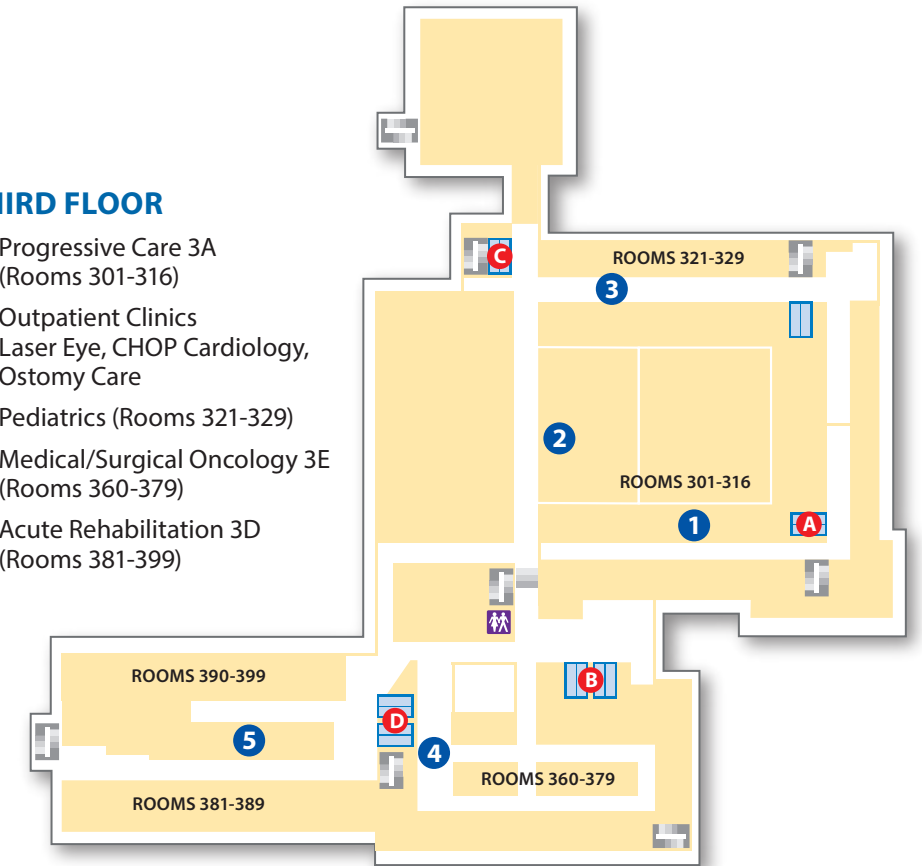

FOURTH FLOOR

- 1 Joint Replacement Center/Orthopaedics
Use elevator D to reach the fourth floor.
(Rooms 480-499)